



# Electrolux

## Modular Cooking Range Line 700XP 6-Burner Gas Range on Large Gas Oven-UK

ITEM # \_\_\_\_\_

MODEL # \_\_\_\_\_

NAME # \_\_\_\_\_

SIS # \_\_\_\_\_

AIA # \_\_\_\_\_



Modular Cooking Range Line

700XP 6-Burner Gas Range on Large Gas  
Oven-UK

371173 (E7GCGI6CLG)

6-burner (5,5 kW each) gas  
range with large gas oven  
(9 kW) - UK

### Short Form Specification

#### Item No. \_\_\_\_\_

To be installed on stainless steel feet with height adjustment up to 50 mm. High efficiency flower flame burners with flame regulator. Flame failure device as standard on burners to protect against accidental extinguishing. Oven chamber with 4 levels of runners. Ribbed oven base plate. Exterior panels of unit in stainless steel with Scotch Brite finish. Pan supports in heavy duty cast iron. One piece pressed work top in 1.5 mm thick stainless steel. Right-angled side edges to allow flush-fitting junction between units.

### Main Features

- Unit to be mounted on stainless steel feet with height adjustment up to 50 mm. Unit can be easily mounted on cantilever systems.
- Gas appliance supplied for use with natural or LPG gas, conversion jets supplied as standard.
- Large sized pan support in cast iron (stainless steel as option) with long center fins to allow the use of the largest down to the smallest pans.
- Burners with optimized combustion.
- Flame failure device on each burner protects against gas leakage when accidental extinguishing of the flame occurs.
- Protected pilot light.
- Base compartment consists of a large gas heated standard oven with stainless steel burners and self stabilizing flame positioned beneath the base plate. Oven chamber to have 3 levels of runners to accommodate 2/1 GN shelves (2 steam pans) and ribbed cast iron base plate.
- Oven thermostat adjustable from 120 °C to 280 °C.
- 40 mm thick oven door for heat insulation.
- The special design of the control knob system guarantees against water infiltration.
- IPX5 water protection.

### Construction

- Unit is 930 mm deep to give a larger working surface area.
- All exterior panels in Stainless Steel with Scotch Brite finishing.
- AISI 304 stainless steel worktop, 2mm thick.
- Model has right-angled side edges to allow flush fitting joints between units, eliminating gaps and possible dirt traps.

APPROVAL: \_\_\_\_\_



Electrolux

700XP 6-Burner Gas Range on Large Gas Oven-UK  
Modular Cooking Range Line

### Optional Accessories

- 4 wheels, 2 swivelling with brake (700/900XP). It is mandatory to install with base supports for feet/wheels. PNC 206135  
☐
- Flanged feet kit PNC 206136  
☐
- Flue condenser for 1 module, 150 mm diameter PNC 206246  
☐
- Right and left side handrails PNC 206307  
☐
- Flue condenser for 1/2 module, 120 mm diameter PNC 206310  
☐
- Wok pan support for open burners (700/900) PNC 206363  
☐
- Base support for feet or wheels (lateral ) for pastacooker PNC 206371  
☐
- Base support for wheels (lateral) for 23lt fryers and pastacookers (900) PNC 206372  
☐
- 4 wheels, 2 swivelling with brake (700/900). It is mandatory to install with base supports for feet/wheels. - UK PNC 206382  
☐
- 2 side covering panels, h=700mm, d=700mm PNC 216000  
☐
- Frontal handrail 800mm PNC 216047  
☐
- Frontal handrail 1200mm PNC 216049  
☐
- Frontal handrail 1600mm PNC 216050  
☐
- Large handrail - portioning shelf, 400mm PNC 216185  
☐
- Large handrail - portioning shelf, 800mm PNC 216186  
☐
- Double burner smooth plate for direct cooking PNC 921684  
☐
- Double burner ribbed plate for direct cooking PNC 921685  
☐
- Pressure regulator for gas units PNC 927225  
☐



**Electrolux**

## Modular Cooking Range Line 700XP 6-Burner Gas Range on Large Gas Oven-UK

Front

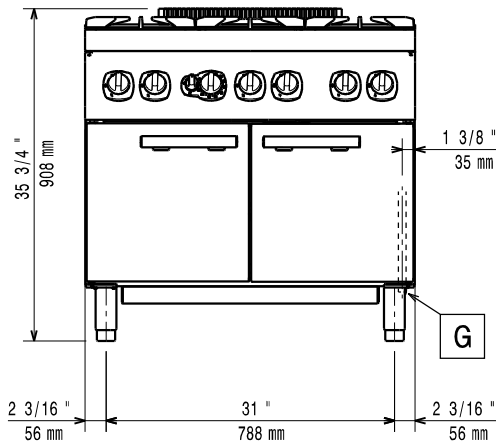

Top

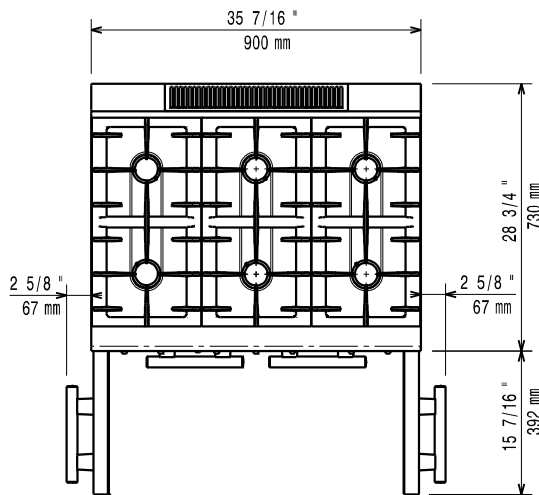

EQ = Equipotential screw  
G = Gas connection

Side

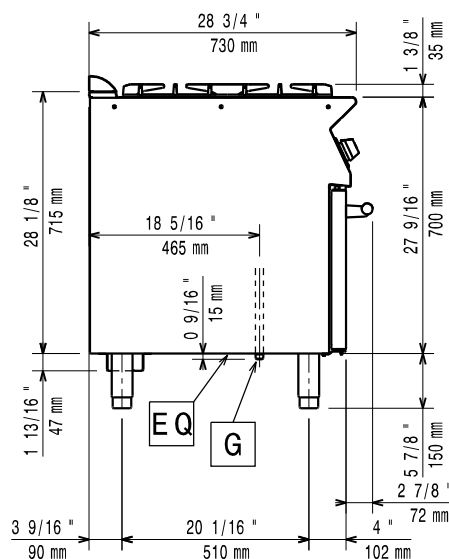

### Gas

#### Gas Power:

371173 (E7GCGI6CLG) 143178 Btu/hr (42 kW)

Gas Type Option: LPG;Town

Gas Inlet: 1/2"

Natural gas - Pressure: 7" w.c. (17.4 mbar)

LPG Gas Pressure: 11" w.c. (27.7 mbar)

### Key Information

Front Burners Power	5.5 - 5.5 kW
Back Burners Power	5.5 - 5.5 kW
Middle Burners Power:	5.5 - 0/5.5 - 0 kW
Back Burners Dimension - mm	Ø 60 Ø 60
Front Burners Dimension - mm	Ø 60 Ø 60
Middle Burners Dimension - mm	Ø 60 Ø 60
Oven working Temperature:	110 °C MIN; 300 °C MAX
Oven Cavity Dimensions (width):	760 mm
Oven Cavity Dimensions (height):	390 mm
Oven Cavity Dimensions (depth):	540 mm
Net weight:	106 kg
Shipping weight:	115 kg
Shipping height:	1100 mm
Shipping width:	820 mm
Shipping depth:	1000 mm
Shipping volume:	0.9 m <sup>3</sup>

If appliance is set up or next to or against temperature sensitive furniture or similar, a safety gap of approximately 150 mm should be maintained or some form of heat insulation fitted.



Modular Cooking Range Line  
700XP 6-Burner Gas Range on Large Gas Oven-UK

The company reserves the right to make modifications to the products without prior notice. All information correct at time of printing.

2015.06.15